



pine house

by Stories Apartments

«TO TRAVEL IS TO LIVE»

— Hans Christian Andersen

Travel is the only thing you buy that makes you richer.



YOUR HOME ON WHEELS, WHERE YOU CAN BREATHE FREELY,
ENJOYING THE FREEDOM AND FRESH AIR

ENJOY PEACE AND BEAUTY IN THE ARMS OF NATURE



STEP INTO YOUR
HOME MADE OF
NATURAL PINE

DISCOVER THE AMAZING
«BREATHING HOUSE» CONCEPT



LIVING IN A 100% ECOLOGICAL PINE HOUSE IS MORE THAN A MATTER OF MATERIAL SELECTION, IT IS A LIFESTYLE BLENDING NATURE AND ARCHITECTURE INTO A HARMONIOUS SYNERGY



PINE IS A NATURAL AND DURABLE MATERIAL THAT OFFERS A WARM, INVITING AMBIENCE, WHILE ALSO ADDING A TOUCH OF FRESHNESS TO YOUR SPACE



PINE IS NOT JUST A MATERIAL, BUT ALSO A SOURCE OF INSPIRATION FOR CREATING AN INTERIOR WHERE NATURE COMES TO LIFE



THE SMART DESIGN OF THE HOUSE STRUCTURE ENSURES
SAFETY, DURABILITY AND BALANCE ON THE ROADS



THE HIGH MOBILITY OF THE HOUSE ALLOWS YOU TO CHANGE THE
VIEW FROM THE WINDOW ACCORDING TO YOUR MOOD

WELCOME TO YOUR PERFECT HOUSE MADE OF PINE WOOD – YOUR PINE HOME



The pine wood home has a cozy and natural look.

Fiberboard, an eco-friendly and durable material, ensures the house stays warm and quiet.

Flax and hemp provide insulation, creating a comfortable climate inside the house.

Hemp wool serves as a natural rodent repellent, making it an excellent insulation material for deterring pests.



You will always breathe easy in a house made of pine.

Pine is one of the oldest medicinal plants, known for its strong bactericidal and antiviral effects, boosting the body's defenses.

The pure air of pine forest is renowned for its healing power.

Pine wood is an environmentally friendly construction material.

Interestingly, even after sawing and processing, pine wood continues to emit phytoncides.

Living in a house made of pine wood, you will benefit from salutary ambience and clean air for many years to come.

Pine wood is saturated with essential oils widely used in aromatherapy, providing a beneficial effect on the upper respiratory tract, relieving tension and stress, boosting immunity, and promoting rapid recovery.



YOUR DREAMS OF A HEALTHY AND
COMFORTABLE LIFE FOR YOUR
FAMILY WILL COME TRUE IN YOUR
PINE HOME



TECHNICAL SPECIFICATIONS

The materials used in the house manufacturing process are environmentally friendly, suitable for recycling, with a residue-free production process, which reduces CO2 emissions and ensures a 95% recycling rate.

These eco-friendly and energy-efficient houses not only provide a healthy and comfortable living space but also contribute to minimizing their impact on the environment.

Status of the house

Record in the technical passport - Box trailer

Operational weight of the house without equipment - 3 380 kg

The category of driver's license required for the transportation of the house - category BE

Platform - a special trailer EMMIX VTA, designed by the manufacturer for the construction of mini houses

The maximum speed when transporting the house - 80 km/h

Structure dimensions

Structure's height from the ground - 3.9 m

Width - 2.55 m

Length - 7.2 m

Total area - 18 m²



Finishing materials

Structure materials - wood, metal

Insulation materials - wood fibre, hemp wool

Roof - metal rolling profile

Facade - wood and metal rolling profile

Finishing - decorative pine wood flooring board painted with eco linen oil paint Raitums Paint

Windows - insulated single-chamber aluminum windows with argon filling and double-leaf entrance doors

Floor covering - floor board Classic coated with high-resistance varnish on a water base

Internal walls - pine wood flooring board painted with eco linen oil paint Raitums Paint

Engineering communications

Electricity - The house shall be connected to an external source of electricity.

32A or 16A and 3- phase (5 pin) connections are suitable for the house power supply.

Water - The house shall be connected to an external source of water supply.

The house is equipped with:

- 150 liters water tank
- Water heater (15 l)
- DAM water pump

Sewage

- incinerating toilet CINDI Family
- outlet for technical water

Ventilation

- natural ventilation
- a fan built into ceiling lamps

Heating

- electric heaters are used for heating

Basic equipment of the house

Living room

- LED ceiling lamps with fan function
- wall lighting
- sockets and switches
- prepared water supply and sewage connection points

Shower room

- built-in ceiling light fixture
- mirror with illumination over the sink
- shower cabin
- incinerating toilet CINDI Family
- pine cabinet for sink with mixer
- forced ventilation fan
- water heater
- built-in wardrobe

Facade

- wall lighting on the facade
- sockets

Add-ons

Living room

- kitchen furniture of solid pine
- kitchen appliances - stove, refrigerator, dishwasher, oven
- table
- folding double sofa



Wooden steps - can be placed near the exit from the house

Wooden terrace - 10 m²

House plan

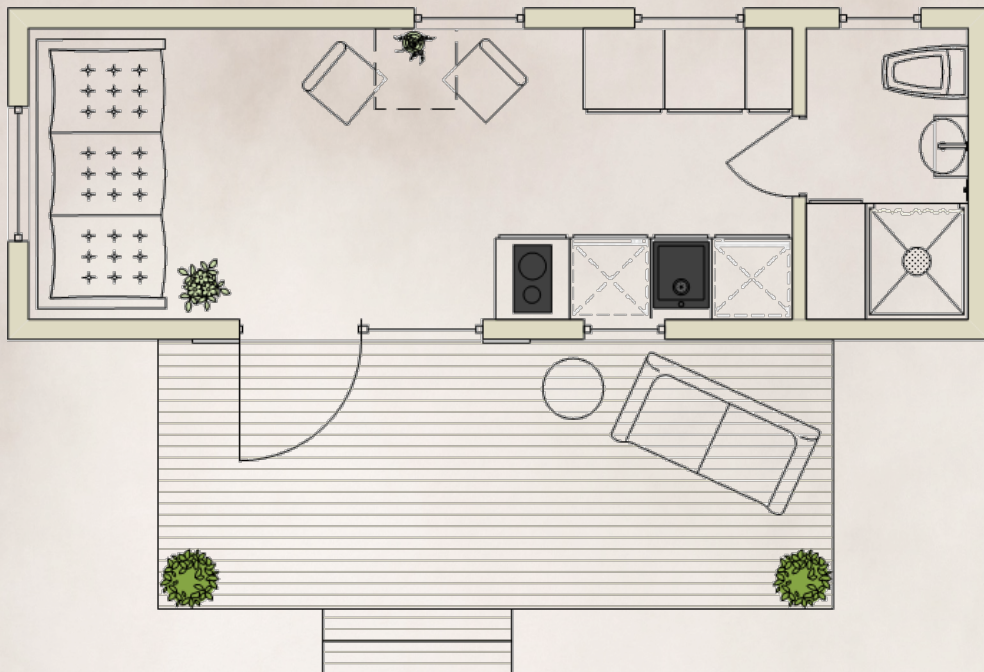

Prices *

Standard price of the house - 70 000 EUR

Optional extras:

Folding sofa - 500 EUR

Ready-built kitchen - 1 600 EUR

Kitchen appliances (stove, refrigerator, dishwasher, oven) - 900 EUR

Wooden steps - 200 EUR

Terrace - 1 200 EUR

* Prices are provided without VAT





pine house

SIA «Joma 9»

Jūrmala, Turaidas iela 19, LV-2015
+37129496212 (WhatsApp, Telegram)
info@joma9.com , www.joma9.com